

Dear Customer,

For safety reasons, we'll be making some changes to the temporary road layout at the A45 Chowns Mill junction:

From Friday 4 June, drivers will notice a change in alignment to the traffic barriers on the A6 Southbound approach and A45 Westbound approach.

Highways England would also like to advise customers that from Saturday 5 June, between the central Island and the A45 WESTERN Arm (below), the lanes will be reduced to one lane for safety reasons

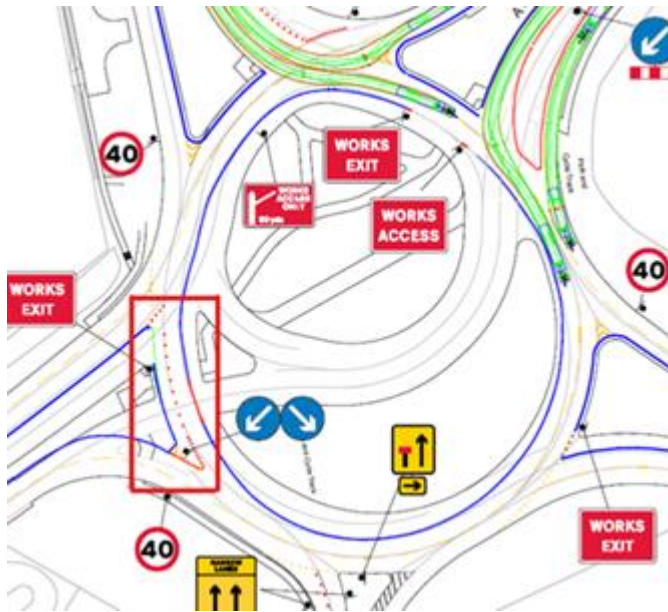

We advise drivers to take extra care whilst using the new road layout and to allow more time for their journeys

We'd like to remind you of this weekend's road closures:

DATE	CLOSURE DETAILS	TIMES
Sat 5 June	Daytime closure of the A6 Northbound/Southbound between Chowns Mill RBT. and Nene Park RBT. (Irthlingborough)  <b>Network Rail Information:</b> (Sunday is a Contingency ONLY) A45 Westbound from Rushden Lakes to Wellingborough (inc. A45 WB slip road from Ditchford lane A5001 closed)	7am to 7pm  10.30pm to 6am
Sun 6 June	Daytime closure of the A6 Northbound/Southbound between Chowns Mill RBT. and Nene Park RBT. (Irthlingborough)	8am to 7pm

**NOTE:** Signed diversion routes will be in place during any closures. Our planned closures may be subject to change due to weather conditions or unforeseen circumstances. Where possible, we will notify you if there are any changes to the schedule.

## **Customer Communication Survey**

Customers are at the heart of what we do, and we want to hear your views about how you think we're communicating with you about A45 Chowns Mill improvement scheme.

To give us your views, please complete our online [survey](#). Or putting this address in your browser: <https://forms.office.com/r/XLwqFdnSkz>

The survey should only take 5 mins to complete. Your views are important to us and will help us improve the way we communicate with you.

## **Keeping Informed**

For information about the scheme, please visit our webpage:

[www.highwaysengland.co.uk/projects/a45a6-chowns-mill-roundabout-improvement/](http://www.highwaysengland.co.uk/projects/a45a6-chowns-mill-roundabout-improvement/)

To receive text alerts about future A45 Chowns Mill road closures, please text **A45CM** to **07537 439499**. Messages will be charged at your standard network text message rate.

To unsubscribe, please text A45CM STOP to the same number.

For more information, or to be removed from the mailing list, please email:

[infoA45chownsmill@carnellgroup.co.uk](mailto:infoA45chownsmill@carnellgroup.co.uk)